



Change the password for your *MyIMD* account

Walkthrough



1

When logged in your *MyIMD* account, click on your profile icon

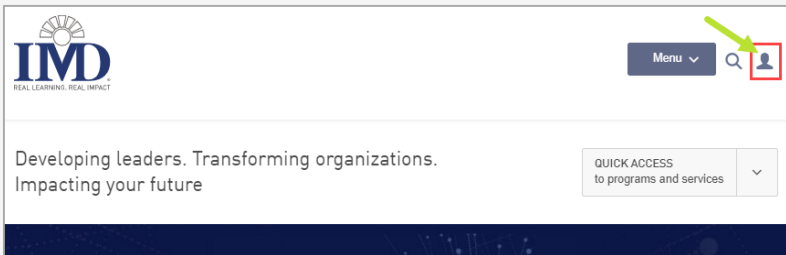

2

Click on the **MyIMD** link

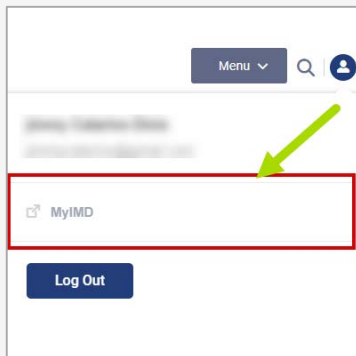

3

Click on your profile icon, then click on **Account settings**

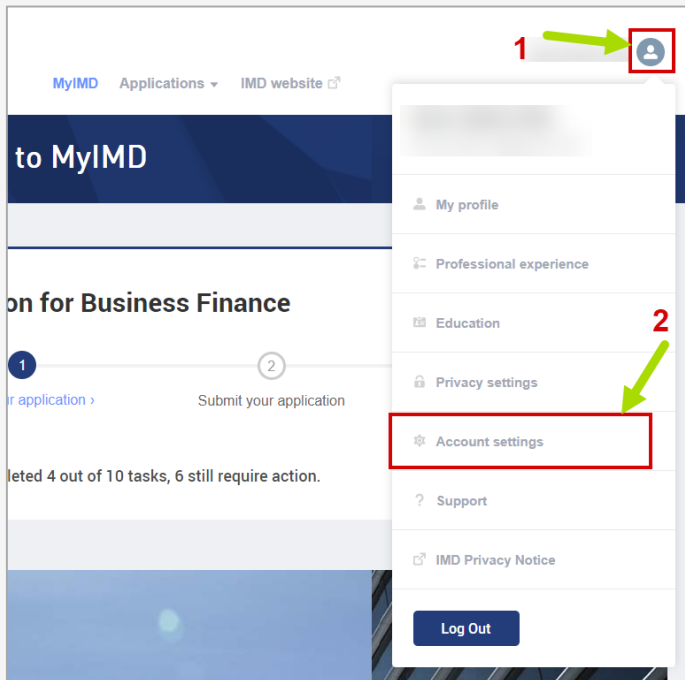

4

Enter your current password and a new password following the requirements. Click **Save**

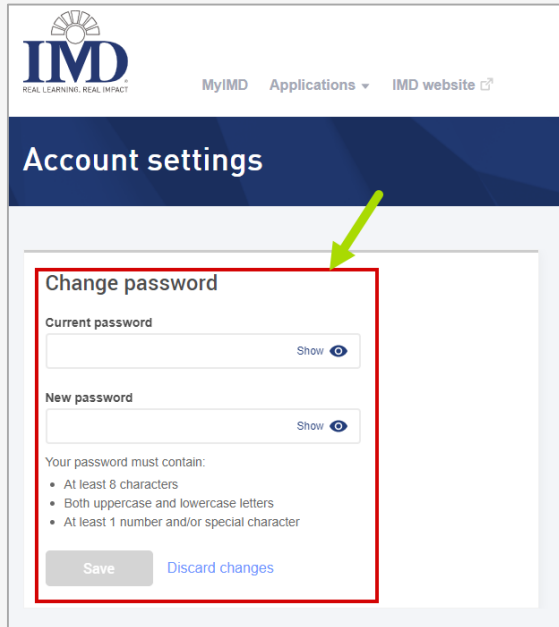

The screenshot shows the 'Account settings' page with the 'Change password' form highlighted. The form includes two password input fields, each with a 'Show' button and an eye icon. Below the fields are the password requirements and two buttons: 'Save' and 'Discard changes'.

Change password

Current password

Show 

New password

Show 

Your password must contain:

- At least 8 characters
- Both uppercase and lowercase letters
- At least 1 number and/or special character

[Discard changes](#)

Need help?



For any question or issue you may have,
please contact the **IT Helpdesk**

- call us: +41 21 618 0789
- open a ticket: <https://support.imd.org>
- get online support: <https://help.imd.org>
- send an email: ITHelpdesk@imd.org

Opening hours (CET)
Mon-Fri: 8:00 – 18:00